

PEIKER | CEE

Communication device

CEEEOACH^{PLUS}

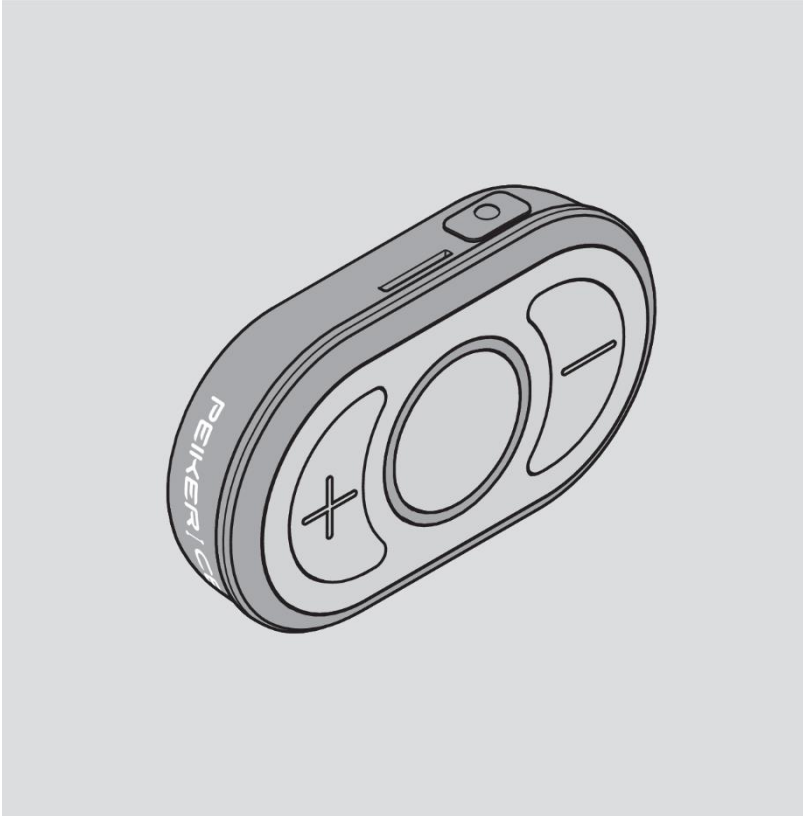

Quick guide

German original instruction

12/2023

Notes on the instructions and the manufacturer

This manual will help you to put the CEECOACH communication device into PLUS⁺ operation. This manual is an excerpt from the detailed user manual. The user manual can be found on our website. You must read and understand both manuals and observe and follow all information, especially the safety instructions.

Design features in the text

Normal text

- Enumeration
- ▶ Action steps
- ⓘ Tips contain additional information.

Manufacturer address

peiker CEE GmbH

Gartenstrasse 25

D-61352 Bad Homburg, Germany

Tel.: +49-6172-1797-500

Email: info@peiker-cee.com; ceecoach@peiker-international.com

Internet: www.peiker-cee.com; www.peiker-international.com

Design features of the warning labels

 WARNING	
	Notes with the word WARNING warn of a dangerous situation that can possibly lead to death or serious injury.
 CAUTION	
	Notes with the word CAUTION warn of a situation that may result in minor or moderate injury.

Description

Scope of delivery

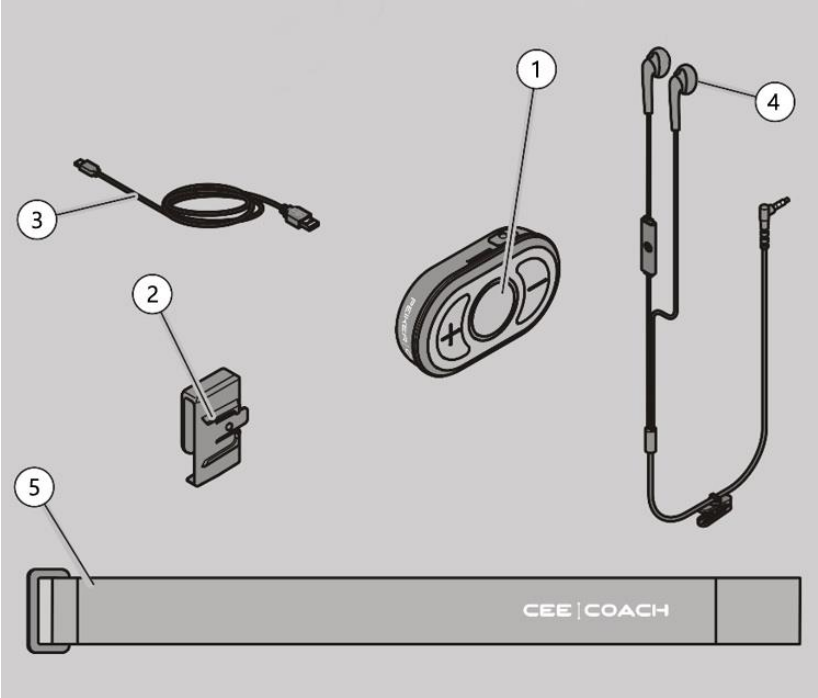

No.	Naming
1	Device (included in duo set 2 times)
2	Belt clip (included in duo set 2 times)
3	USB-C cable (included 2 times in the duo set)
4	Headset (included 2 times in the duo set)
5	Velcro tape (included in duo set 2 times)

Controls

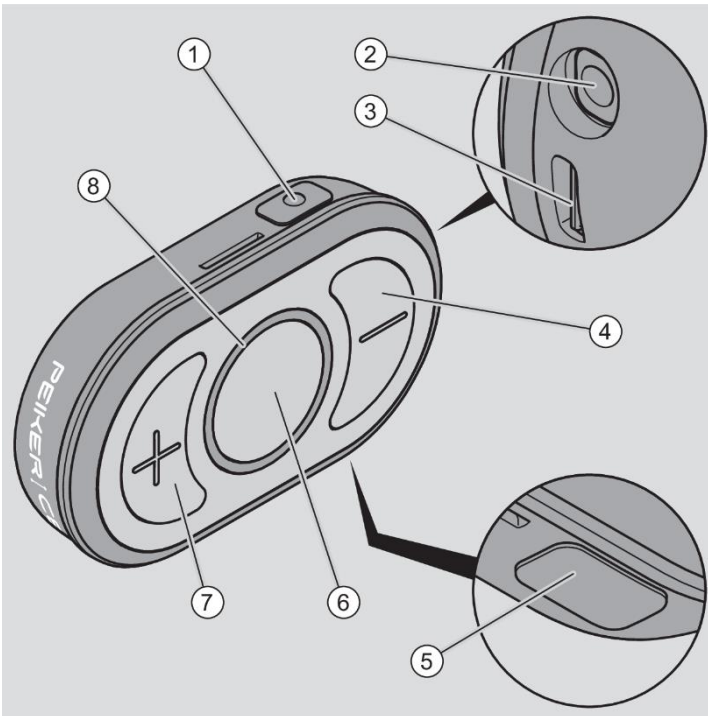



No.	Naming
1	Function key for connecting the device with other devices
2	Connection socket for headset
3	USB socket for USB-C cable
4	Minus key: Decrease volume
5	Function key for connecting the device with other devices or with the Bluetooth® headset.
6	Main key: Switch device on and off Switch microphone on and off
7	Plus key: Increase volume
8	Light ring

Indicators in the illuminated ring

Color	Meaning
Red	Battery almost empty (less than 30% charged)
Yellow	Battery charged between 30 and 70%
Green	Battery more than 70 % charged Device is connected and at least one device is in the transmitting and receiving range
White	There is no connection to other devices
Cyan	Device is connected, but there is no other device in the transmit and receive range
Blue	Device can be connected with a Bluetooth® headset
Magenta	The microphone is switched off

Unpack and check scope of delivery

 WARNING	
	<p>Small parts are included in the delivery. Children can swallow the small parts during play and choke on them.</p> <ul style="list-style-type: none"> ▶ Make sure that the small parts do not get into the hands of children.

- ▶ Remove the parts of the device from the original packaging.
- ▶ Keep the original packaging for possible return.
- ▶ Check if all parts of the device are included.
- ▶ Check the perfect condition of the parts.
- ▶ Contact the manufacturer if any parts are missing or damaged.

Putting the device into operation

- ▶ Switch on the device (see "Switching the device on and off" from page6).
- ▶ Use the headset as described in the manufacturer's instructions.
- ▶ When using a Bluetooth® headset, proceed as described in the user manual.
- ▶ Connect the device to the desired other devices.

You can connect the device with up to 15 other devices in a group (for this see "Forming a group" from page8).

-  The devices in the Duo Set are connected to each other in the delivery state.

Switching the device on and off

- ▶ To turn on the device, press the main button and hold it for at least 3 seconds.

The light ring then shows a color (green, orange or red depending on the battery charge) for 3 seconds. You will also hear the voice prompt "Power on". The light ring flashes 3 times in the color cyan or white if the device is not connected to any other device. Afterwards, the light ring flashes once

every 3 seconds in the color green, if the device is connected to at least one device.

- ▶ To turn off the device, press the main button again and hold it for at least 3 seconds.

The light ring then shows a color (green, orange or red depending on the battery charge) for 3 seconds. You will also hear the voice prompt "Power off".

Switching the microphone on and off (mute function)



- ▶ To turn off the microphone, press the main button briefly.

You hear the voice prompt "Mute on". The light ring flashes magenta. You will now no longer be heard by other connected subscribers.

- ▶ To turn on the microphone, press the main button again briefly.

You hear the voice prompt "Mute off". You will now be heard again by the connected subscribers.

Set volume

 CAUTION	
	Hearing damage possible due to excessively loud noises. ▶ Avoid continuous exposure to sound at maximum volume.

- ▶ To increase the volume, press the Plus button gradually.

The device becomes louder in 1/12 steps. The color display in the illuminated ring becomes larger. At maximum volume, the illuminated ring lights up completely green.

- ▶ To reduce the volume, press the minus key step by step.

The device becomes quieter in 1/12 steps. The color display in the illuminated ring becomes smaller. At minimum volume, only one LED lights up.

- ▶ To quickly change the volume, press and hold the plus or minus button.

Form group

You can form a group with up to 15 other devices. The distance between the devices must be less than 10 m when connecting them.

- ▶ Make sure that the devices to be connected are within range.
 - ▶ Switch on the devices (see "Switching the device on and off" starting on page 6).
 - ▶ Press the function keys (1, 2) on the devices simultaneously for at least one second.
- i** From device to device, you have up to 10 seconds to press the function keys. After that, the group formation is completed. In the event that one or more devices have been forgotten, the group formation must be restarted with all devices.

The light ring fills up during the pairing time for all devices in the pairing state until pairing is complete. You will then hear the voice prompt "Device connected" when at least one other device has been successfully connected. The illuminated ring flashes green.

If no connection has been established, the illuminated ring flashes white.

- ▶ In this case, repeat the procedure.

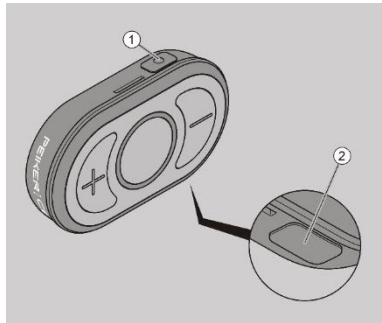

- i** The two devices in the Duo Set are connected to each other in the delivery state.